



45  
kN

L73  $\varnothing$ 25  
mm

R  
3/8"  
BSP

R  
250  
bar

GO/GC  
3/8"  
BSP

GO  
200  
bar

GC  
300  
bar

22.5  
kN

1200  
nm

24  
kg

20  
l/min

Hydraulic rotator FHR 4.500L is cost-effective solution generally for seasonal use in forestry, agriculture, road and building construction, general cargo and material handling.

Rotator's upper mount is applied in EYE form factor of the knuckle joint. Robust and tough built to withstand even overloads. The wide of eye is common standard width 73mm and the knuckle pin diameter 25mm.



FHL 01-A/B-73/25



FHL 01B-A/B-73/25

Rotator lower mount is applied in AXLE form factor to mount in grapple / tool mounting tube or adaptor and by fixing with pin. Axle (shaft) diameter is 59mm and the fixing pin (not included) diameter 30mm

$\varnothing$ 59  $\varnothing$ 30  
mm

GO/GC  
3/8"  
BSP

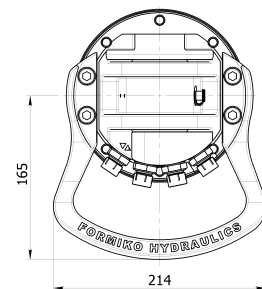
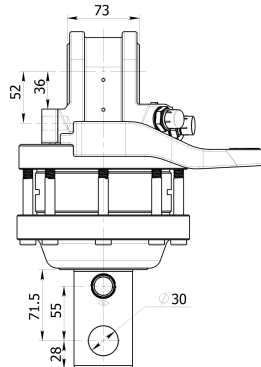
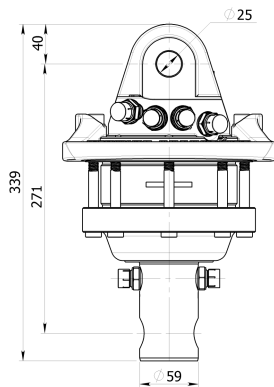

For additional information relating to price levels and technical data, please contact [sales@formiko.lv](mailto:sales@formiko.lv)

**Formiko Hydraulic s Ltd**

Dzirciema Str. 119 k-1,  
Rīga LV1055 LATVIA

+371 294 49 552  
+371 264 59 383  
[sales@formiko.lv](mailto:sales@formiko.lv)  
[www.formiko.lv](http://www.formiko.lv)

On request by special conditions there are metric nipples available for rotator FHR 4.500L



FORESTRY GENERAL CARGO AGRICULTURE CONSTRUCTION





Hydraulic rotator FHR 4.500L is cost-effective solution generally for seasonal use in forestry, agriculture, road and building construction, general cargo and material handling.



Rotator's upper mount is applied in EYE form factor of the knuckle joint. Robust and tough built to withstand even overloads. The wide of eye is common standard width 73mm and the knuckle pin diameter 25mm.



Rotator lower mount is applied in AXLE form factor to mount in grapple / tool mounting tube or adaptor and by fixing with pin. Axle (shaft) diameter is 59mm and the fixing pin (not included) diameter 30mm



Rotator FHR 4.500L based on reliable vane type hydraulic motor which delivers torque up to 1200Nm at 25MPa.



Formoko rotator FHR 4.500L is compatible with FHL 01-A/B-73/25 and FHL 01B-A/B-73/25 series links.



Rotator for shipping is packed in compact solid cardboard box with dimensions 340x230x240mm.



We providing TWO year warranty for this rotator.

For additional information relating to price levels and technical data, please contact [sales@formiko.lv](mailto:sales@formiko.lv)

**Formiko Hydraulic s Ltd**

Dzirciema Str. 119 k-1,  
Riga LV1055 LATVIA

+371 294 49 552

+371 264 59 383

[sales@formiko.lv](mailto:sales@formiko.lv)

[www.formiko.lv](http://www.formiko.lv)

On request by special conditions there are metric nipples available for rotator FHR 4.500L

FORESTRY



GENERAL CARGO



AGRICULTURE



CONSTRUCTION

